

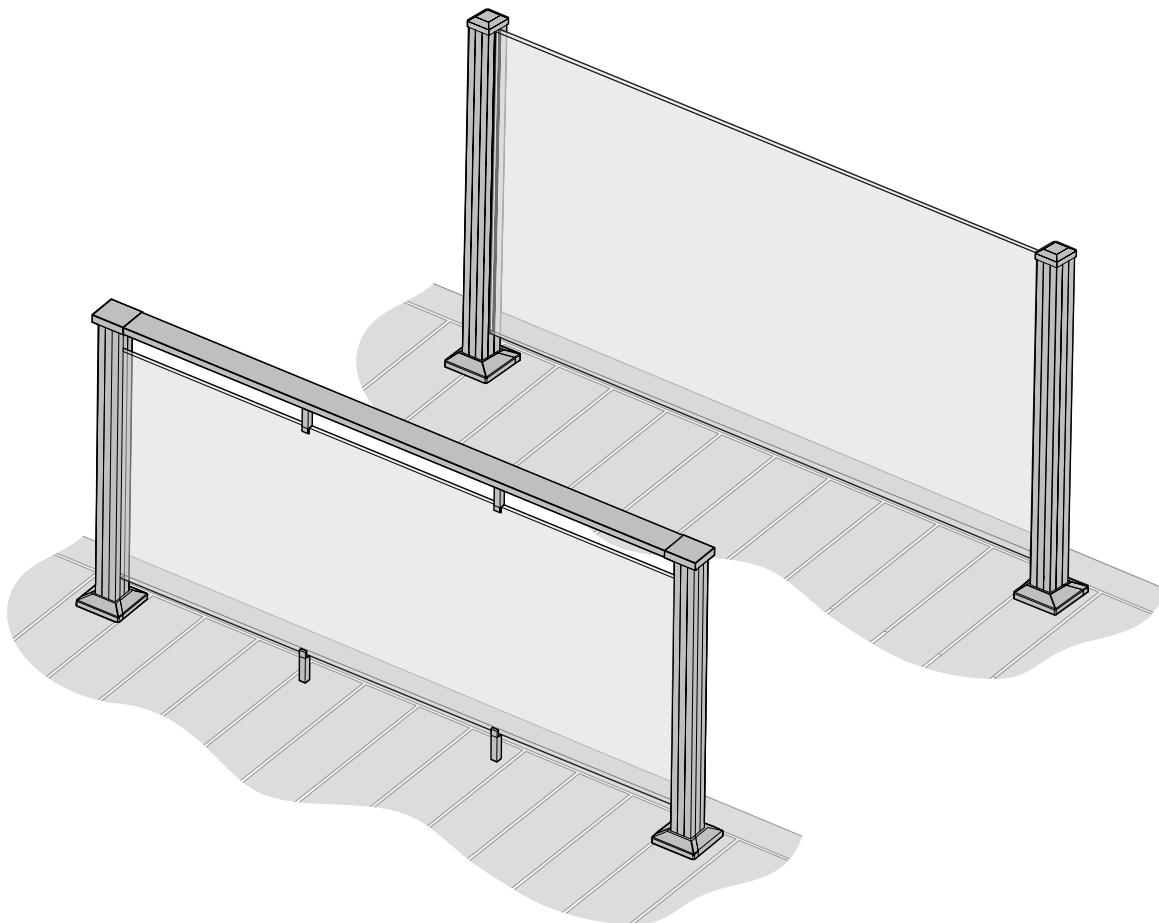

INSTALLATION INSTRUCTIONS

POST TO POST & CONTINUOUS TOP GLASS RAIL



PAGE 2 PARTS AND TOOLS

PAGE 3 INSTALLATION INSTRUCTIONS

PRIOR TO CONSTRUCTION:

Check with your local regulatory agency for special code requirements in your area.

Read these instructions completely for an understanding of how the product fits together and how each part affects the others.

DECKORATORS.COM

PARTS AND TOOLS

PARTS INCLUDED

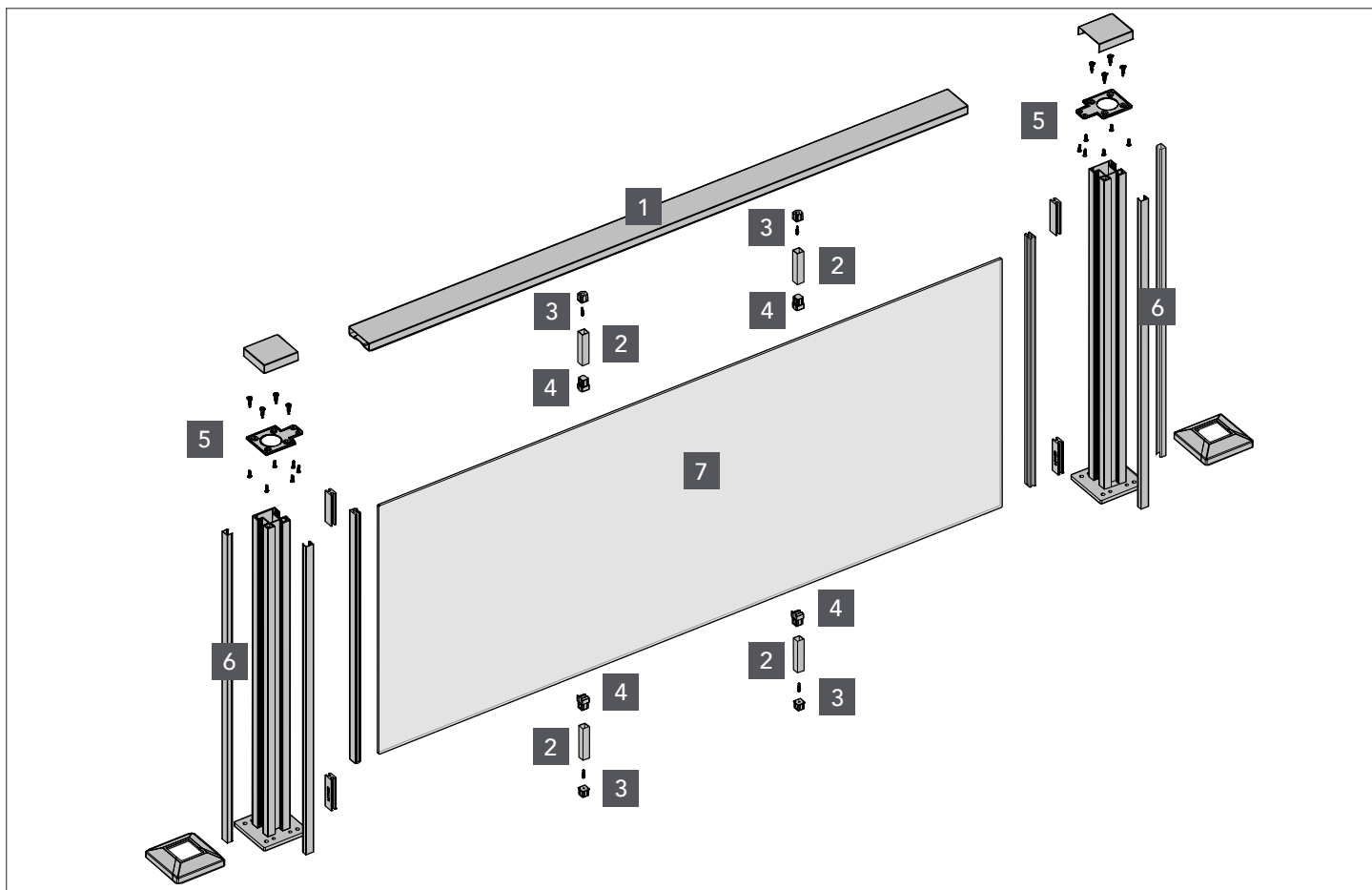

ITEM	NAME	QTY
1	Top Rail	1
2	Support Blocks	4
3	Support Block Connector with #8 x 1" Screw	4
4	Glass Adapter Plugs	4

ITEM	NAME	QTY
5	Continuous Top Rail Brackets (Sold Separately)	1
6	Glass Posts (Sold Separately)	2
7	Glass Panel (Sold Separately)	1

GLASS SPECIFICATIONS FOR 6' ON CENTER POST SPACING

KIT	GLASS PANEL THICKNESS	GLASS PANEL DIMENSIONS
36" With Top Rail	0.25"	70.5" x 28.25"
42" With Top Rail	0.25"	70.5" x 34.25"
36" No Top Rail	0.5"	70.5" x 32.5"
42" No Top Rail	0.5"	70.5" x 38.5"

- For custom lengths, panels should be 1" longer than the span between posts.
- Glass should be tempered, shatterproof, monolithic panels. Some regions require laminated tempered panels. Check with your local jurisdiction for specific glass specifications.

TOOLS REQUIRED

- Power Drill
- 5/32" Drill Bit
- 3/8" Drill Bit
- 15/64" Drill Bit
- 1/8" Drill Bit
- T20 Torx Bit (provided)
- Bit Extenders
- 3/16" Allen Wrench
- Tape Measure
- Pencil
- Glass Cleaner

INSTALLATION INSTRUCTIONS

IMPORTANT NOTES

- Common railing heights are 36" and 42".
- Determine the number of railing posts needed for your deck. Post spacing is 6' on-center. Example: A 12' x 16' deck attached to a building with a 4' access opening on one side requires eight posts. Use as many full panels as possible to minimize cutting.
- If installing low-voltage lighting, install the wiring before securing the posts to the deck surface.
- Drill pilot holes to prevent cracking the support boards.
- Glass edges must be polished and free of any scratches, burrs, or sharp edges.
- At any time during the installation or use of the glass, any indication of cracking, splintering, or other failures, the glass must be removed and replaced immediately.



Scan for additional
information and
installation videos

POST INSTALLATION

1. PREPARE TO INSTALL THE POSTS

1. Add one 4" x 6" treated southern yellow pine block, or two 2" x 8" blocks, between the insides of the joists.
2. Drill pilot holes and securely fasten the blocks in place with #10 x 3" galvanized wood screws (not provided).
3. Make sure the decking is firmly attached to the joist at the location where the posts will be installed.

NOTE: When installing the post on to a wood surface, screws must be lagged into at least 3" of solid wood (not including the decking). 5/4" or 1 1/2" deck boards do not provide sufficient material for a safe installation. If necessary, add additional material to the underside of the surface.

*Joist hardware hidden for simplification

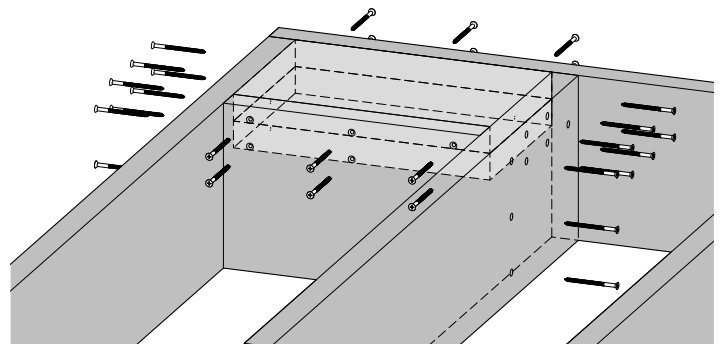

2. INSTALL THE POSTS

1. Place each post in the desired location on the deck and use the four 11/32" diameter mounting holes in each base as a guide to mark the base hole locations.
2. Set the post aside and use a 3/8" drill bit to drill clearance holes only through the decking. Do not drill into the substructure and/or blocking.
3. Use a 15/64" drill bit to drill pilot holes for 5/16" x 4" or longer lag screws through the decking and reinforcement.
4. Attach the two leveling plates with double-sided tape to the bottom of the post so that the plate lies beneath the leveling set screws and the mounting holes are aligned.
5. Reposition each post; then insert and partially tighten the four 5/16" x 4" or longer lag screws (sold separately).
6. Using a level, adjust the leveling set screws with a 3/16" Allen wrench until the post is plumb.
7. Fully tighten the post fasteners to secure the post to the deck structure and verify it is still plumb.

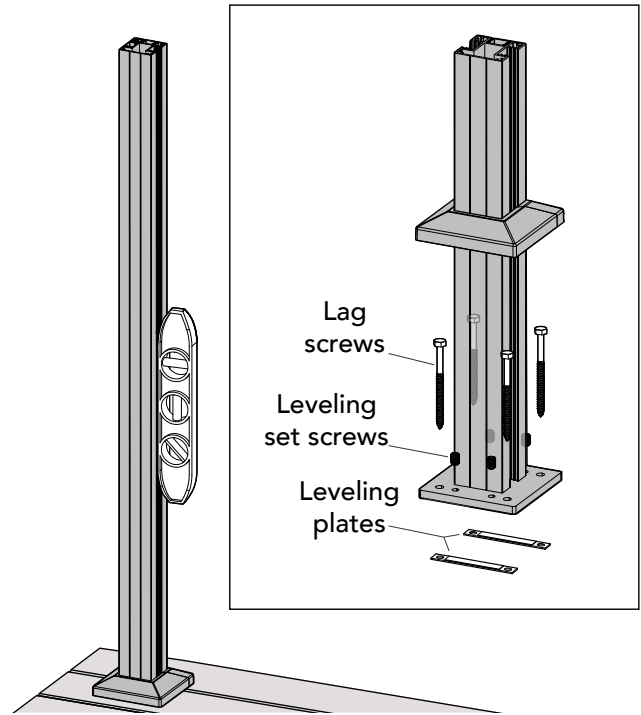

3. INSTALL THE POST SKIRT

If you are installing a one-piece post skirt, install it before moving forward.

NOTE: A two-piece post skirt can be installed at the end of the installation.

4. INSTALL THE LOWER GLASS SPACERS

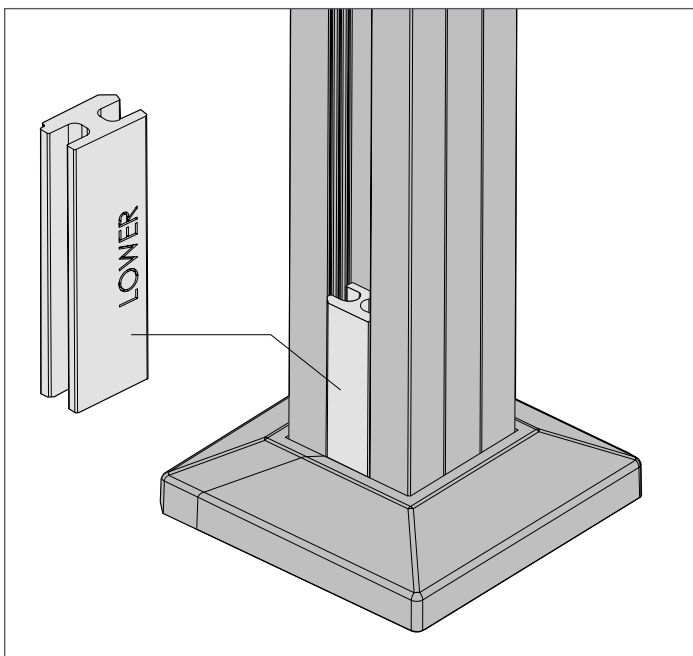

1. Insert the glass spacers labeled "lower" into the inner channel of each post.
2. Slide the glass spacers down the channel to the bottom of each post.

5. INSTALL THE GLASS FILLER STRIPS

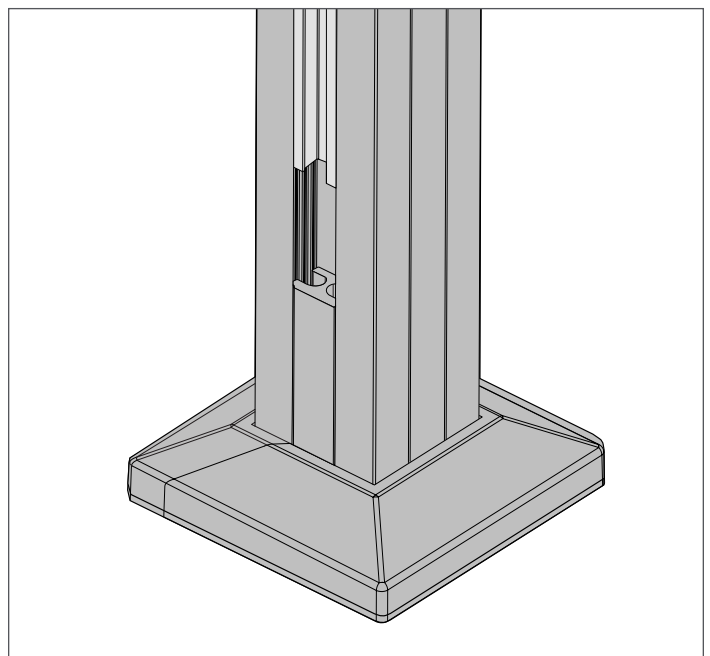

1. Insert the glass filler strips into the inner channel of each post, oriented with the groove facing outward.
2. Slide the glass filler strips down the channel to the bottom of each post.

6. DETERMINE YOUR NEXT STEP

For the top rail 1/4" glass installation, go to the Top Rail 1/4" Glass Installation section.

For the post to post 1/2" glass installation, go to the Post to Post 1/2" Glass Installation section.

TOP RAIL 1/4" GLASS INSTALLATION

1. ATTACH THE SUPPORT BLOCK CONNECTOR(S) TO THE TOP RAIL

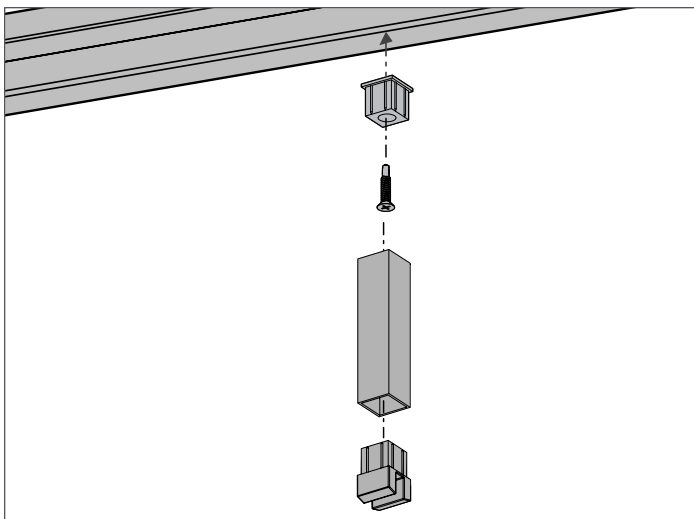

1. Measure the bottom of the surface of the rail and mark the locations for the support block connector(s).

NOTE: Any section of railing between 2' to 4' requires one centered connector. Any section of railing between 4' to 6' requires two evenly spaced connectors.

2. Using a 1/8" drill bit, drill a pilot hole in the marked location(s).
3. Attach the support block connector(s) to the bottom rail using the provided #8 x 1" screw(s).
4. Insert a support block onto each installed connector and insert a glass adapter plug into each support block.

NOTE: Align the groove of the glass adapter plug with the glass panel direction.

2. ATTACH THE SUPPORT BLOCK CONNECTOR TO THE DECK SURFACE

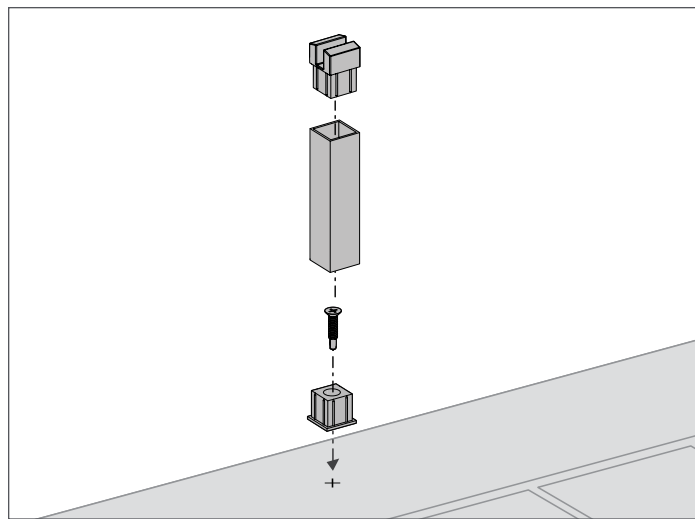

1. Lay the top rail on the deck surface, centered between the posts.
2. Mark the locations of the installed support block connector(s) on the deck surface.
3. Using a 1/8" drill bit, drill a pilot hole in each marked location.
4. Attach the support block connector(s) to the deck surface using the provided #8 x 1" screw(s).
5. Insert a support block onto each installed connector and insert a glass adapter plug into each support block.

NOTE: Align the groove of the glass adapter plug with the glass panel direction.

6. Set the top rail assembly aside until step 5.

3. INSTALL THE 1/4" GLASS PANEL

1. Apply glass cleaner to the opening of the glass filler strips and the side edges of the glass panel for lubrication.
2. Slide the 1/4" glass panel down into the glass filler strips in the posts.
NOTE: Make sure the glass panel slides into the glass adapter plugs.
3. Insert the upper glass spacers into the inner channel of each post.

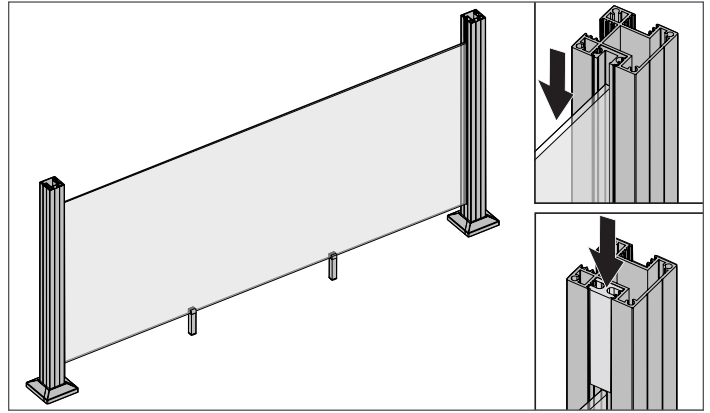

4. ATTACH THE BRACKET BASES (SOLD SEPERATELY)

1. Set a bracket base on top of each post oriented so that the flat side with locating pins is facing down.
2. Attach each bracket base to the post using the four provided 1/4" x 1" screws.

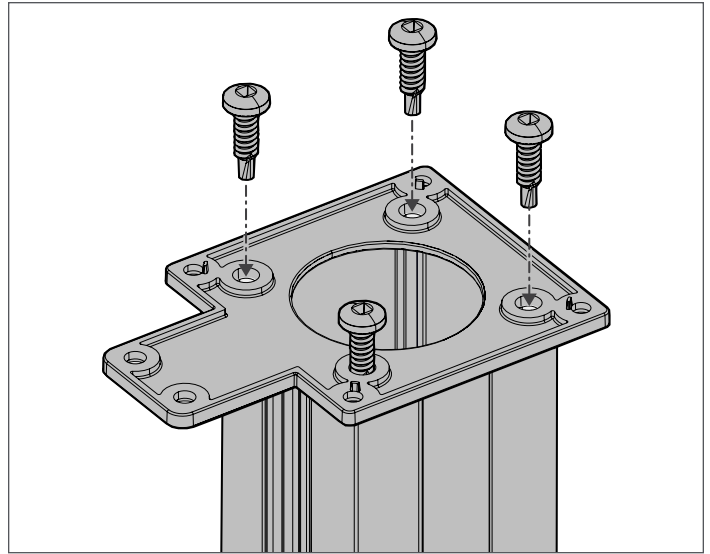

5. INSTALL THE TOP RAIL

1. Set the top rail onto the bracket bases attached to each post.
NOTE: The bottom of the top rail should seat onto the extensions on the bracket bases.
2. Insert the glass panel into the grooves of the glass adapter plugs as you lower the rail into position.
3. Using each bracket base as a guide, use a 5/32" drill bit to drill pilot holes in the bottom of the top rail.
TIP: Use extended bits.
4. Secure the top rail to each bracket base with two of the provided #10 x 3/4" flat-head screws.

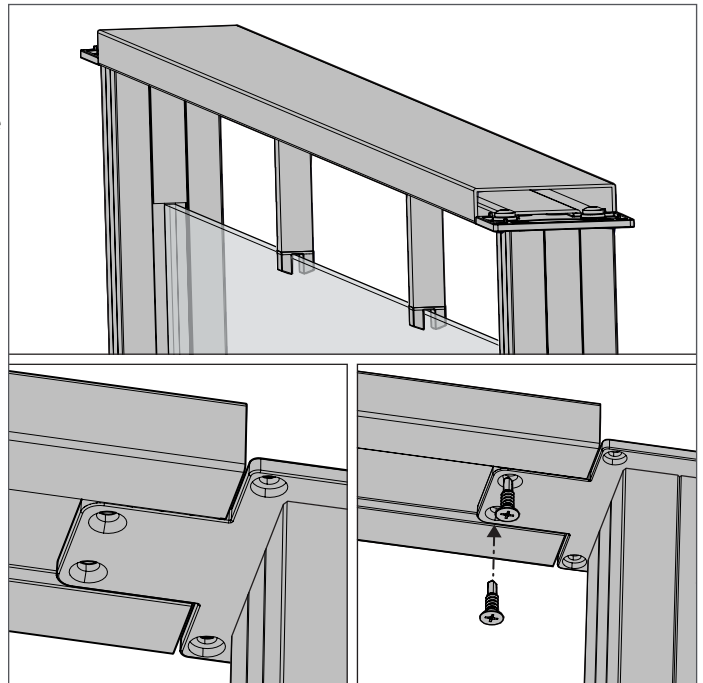

6. ATTACH THE BRACKET COVERS

1. Place a bracket cover over each bracket base.
2. Attach each bracket cover to the bracket base using four of the provided #8 x 5/8" pan-head screws.

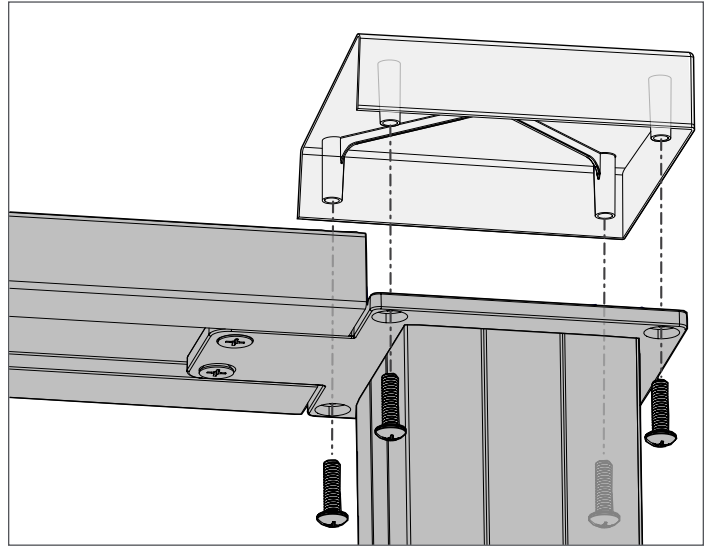

POST TO POST 1/2" GLASS INSTALLATION

1. INSTALL THE 1/2" GLASS PANEL

1. Apply glass cleaner to the opening of the glass filler strips and the side edges of the glass panel for lubrication.
2. Slide the 1/2" glass panel down into the glass filler strips in the posts.
3. Slide a post cap onto the top each post.

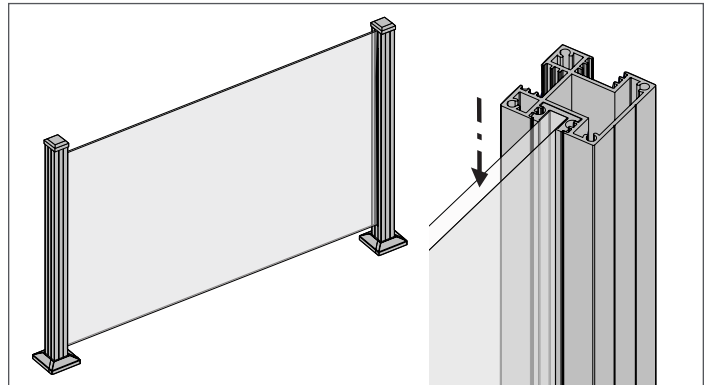

THE DIAGRAMS AND INSTRUCTIONS IN THIS BROCHURE ARE FOR ILLUSTRATION PURPOSES ONLY AND ARE NOT MEANT TO REPLACE A LICENSED PROFESSIONAL. ANY CONSTRUCTION OR USE OF THE PRODUCT MUST BE IN ACCORDANCE WITH ALL LOCAL ZONING AND/OR BUILDING CODES. THE CONSUMER ASSUMES ALL RISKS AND LIABILITY ASSOCIATED WITH THE CONSTRUCTION OR USE OF THIS PRODUCT. THE CONSUMER OR CONTRACTOR SHOULD TAKE ALL NECESSARY STEPS TO ENSURE THE SAFETY OF EVERYONE INVOLVED IN THE PROJECT, INCLUDING, BUT NOT LIMITED TO, WEARING THE APPROPRIATE SAFETY EQUIPMENT. EXCEPT AS CONTAINED IN THE WRITTEN LIMITED WARRANTY, THE WARRANTOR DOES NOT PROVIDE ANY OTHER WARRANTY, EITHER EXPRESS OR IMPLIED, AND SHALL NOT BE LIABLE FOR ANY DAMAGES, INCLUDING CONSEQUENTIAL DAMAGES.